

# Stainless Steel 316 Ball Valve

F&F Mini

PRODUCT DATASHEET

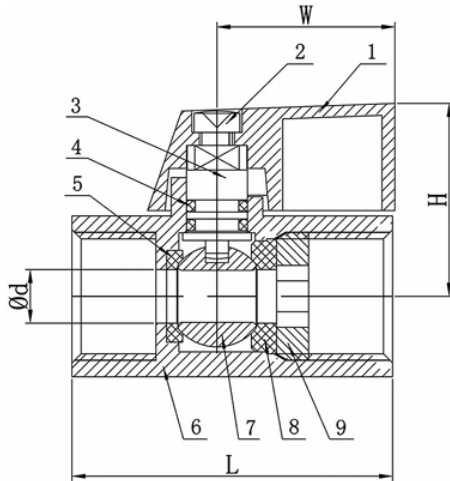

## Features

- Suitable for isolating hot & cold non-potable water, oil and gas (WOG)
- Flow will occur when the lever is in line with the body of the valve
- The compact nature of the valve allows for installation in tight areas
- Comes with a blow-out proof stem design
- Commonly used in the food processing and chemical service industries

## Specifications

- Max Pressure Rating: 1000 psi (6895 kPa)
- Working Temperature Range: -20 to 180°C
- Thread: BSP to ISO 228
- Reduced Bore

## Dimensions (mm)

Size	ØD	L	H	W
6mm (1/8")	6.5	40	25	23
8mm (1/4")	7	42	25	23
10mm (3/8")	7	42	25	23
15mm (1/2")	9.2	46	27.5	23
20mm (3/4")	12.5	54	31	23
25mm (1")	15	65	34.5	23

## Materials

#	Part	Material
1	Handle	Aluminium Alloy
2	Bolt	304 Stainless Steel
3	Stem	304 Stainless Steel
4	"O" Ring	NBR Rubber
5	Ball Seat (A)	PTFE Teflon
6	Body	CF8M Stainless Steel
7	Ball	304 Stainless Steel
8	Ball Seat (B)	PTFE Teflon
9	Cap	CF8M Stainless Steel

## Warranty

24 months

### For Further Information

📧 [info@valvewarehouseaustralia.com.au](mailto:info@valvewarehouseaustralia.com.au)

☎ 03 9421 0042

Valve Warehouse ABN 33 632 515 149