

Features:

Pressure Range: 0 kpa to 4000 kpa (600 psi)

Body: Stainless Steel

Function: Dual Scale Kpa/PSI glycerine filled pressure gauge

Connection: 1/4" BSP Bottom Entry

Factory Accredited: CE, ISO 9001, TUV



Description:

High-Quality Liquid Filled Pressure Gauge suitable for measuring Water Pressure and Air Pressure.

Our 63mm Dial Pressure Gauge with 8mm (1/4 inch) BSP Back Entry Brass Thread ranges from 0 – 400 KPA (60 PSI) to 0 – 4000 KPA (600 PSI) and is Manufactured with a Stainless Steel Housing.

EVF pressure gauges have been proven reliable and efficient since 1991 and maintained at a competitive price.

Model	Range
LFPGBE-0-400	0 – 400 kpa
LFPGBE-0-600	0 – 600 kpa
LFPGBE-0-800	0 – 800 kpa
LFPGBE-0-1000	0 – 1000 kpa
LFPGBE-0-1600	0 – 1600 kpa
LFPGBE-0-2500	0 – 2500 kpa
LFPGBE-0-4000	0 – 4000 kpa
Size	100mm (4")
Accuracy	+/- 2.5%
Range	Depends upon model
Work Pressure	3/4 of full scale
Fluctuating pressure	2/3 of full scale
Short Time Pressure	Full Scale
Operating Temperature	-10°C to 60°C
Media	Compatible gases and liquids
Housing	304 Stainless Steel Case and crimped ring
Window	Polycarbonate
Liquid Filled	Glycerine
Bourdon Tube	Copper alloy
Movement	Copper alloy
Connection	Brass
Thread	BSP
Scale	Dual Scale Kpa/Psi

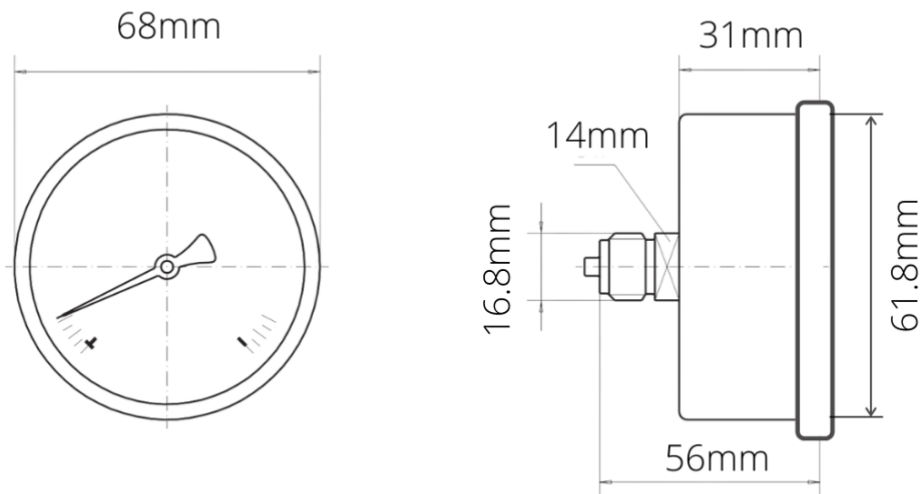
Dimensions:

Phone: 03 5480 6866

Address: 5 Mitchell St, Echuca VIC 3564

Email: orders@echucavalves.com.auWebsite: echucavalves.com.au**WARNING**

These products are intended for use in industrial applications only. Do not use these products where pressures and temperatures can exceed those listed under 'Technical Data' and in our individual 'Series' data sheets. Before using these products with fluids other than those specified, for non-industrial applications, life-support systems, or other applications not within published specifications, consult EVF Pty Ltd. Through misuse, age, or malfunction, components used in industrial valve applications can fail in various modes. The system designer is warned to consider the failure modes of all component parts used in industrial valve applications and to provide adequate safeguards to prevent personal injury or damage to equipment in the event of such failure. System designers must provide a warning to the user in the system instructional manual if protection against a failure mode cannot be adequately provided. System designers and end users are cautioned to review specific warnings or specifications found in instruction sheets or labels packed or attached and shipped with the products. Our policy is one of continuous research and development. We therefore reserve the right to amend without notice the specifications given in this document or our individual 'Series' data sheets.

WARRANTY INFORMATION

All valve series and other products manufactured or distributed by EVF Pty. Ltd. are warranted by EVF to be free of defects in material and workmanship for a period of 1 year from the date of purchase or as the manufacturer warrants. EVF obligation under this warranty is limited to repair or replacement of the defective product or refund of the purchase price paid solely at the discretion of Process Systems and provided such defective product is returned to Process Systems freight prepaid and upon examination by EVF such product is found defective. This warranty shall be void in the event that the product has been subject to misuse, misapplication, improper maintenance, modification or tampering. This warranty is expressed in lieu of all other warranties, expressed or implied from EVF Pty. Ltd. representatives or employees. EVF reserves the right to change Valve and Brochure specifications without notice.